



**WACKER  
NEUSON**  
*all it takes!*

## EZ53

Tracked Zero Tail Excavators



### EZ53 Zero tail swing offers excellent maneuverability

The EZ53 compact excavator combines the performance of a conventional track excavator with the excellent maneuverability of a zero tail swing machine. When revolved, the tail of the EZ53 does not project over the width of the tracks. Powered by an economical Tier 4 Final Perkins engine, this unit offers rubber tracks, dozer blade, boom mounted working light and control pattern change system. The excavator is offered in a canopy or full cab version each with a short or longer dipperstick. Cab models feature standard air conditioning.

- Zero tail swing and compact dimensions are ideal for working in confined areas
- Large operator station is ergonomically designed for easy access and operator comfort improving productivity
- Unit equipped with pattern control selector for versatility and ease of use
- Tilttable operators platform allows for easy accessibility to all maintenance components
- Optional Vertical Digging System (VDS): It enables progressive tilting of the superstructure by up to 15° to compensate for slopes up to 27%

#### VDS - Vertical Digging System

VDS enables progressive tilting of the superstructure by up to 15° with the push of a button, allowing the operator to compensate for slopes up to 27%. This makes precise vertical digging possible even on the most uneven of terrain. Cost-effectiveness and user comfort thus get a considerable boost.

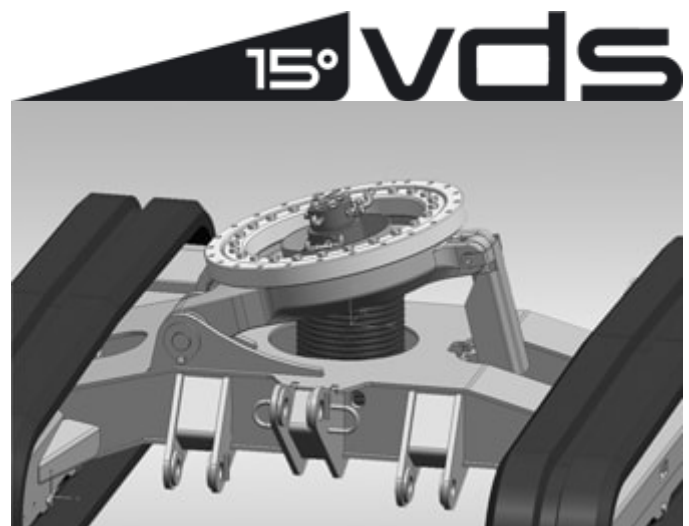



## EZ53 Technical specifications

### Operating data

Shipping weight min.	10,937 lb
Operating weight	11,539 - 14,178 lb
Biting force max.	6,295 lbf
Breakout force max.	8,565 lbf
Digging depth max.	147.7 in
Dumping height	144.8 - 155.2 in
Digging radius max.	245.4 in
Superstructure slewing speed	9.2 rev/min
L x W x H	216.5 x 78.3 x 101.3 in

### Engine / Motor

Engine / Motor manufacturer	Perkins
Engine / Motor type	404F-22T
Engine / Motor	Water-cooled 4-cylinder diesel engine EPA III
Displacement	135.2 in <sup>3</sup>
RPM / speed	2,440 rpm
Engine performance acc. to ISO	58.9 hp
Battery	88 CCA
Fuel tank capacity	21.9 US gal

### Hydraulic system

Duty pump	Double variable- & two-gear pump
Flow rate	41.6 US gpm
Operating pressure for working and traction hydraulics	3,336 psi
Operating pressure Slewing gear	2,756 psi
Hydraulic oil tank	19.3 US gal

### Undercarriage

Travel speed max.	2.9 mph
Chain width	15.7 in
Ground clearance	12.7 in

### Dozer Blade

Width	78.3 in
Height	15 in
Stroke - Above ground	16.3 in
Stroke - Below ground	17.9 in



**WACKER  
NEUSON**  
*all it takes!*

### Sound level

---

Sound level (LwA) acc. to 2000/14/EC	94 dB(A)
Cabin - specified sound pressure level LpA acc. to ISO 6394	78 dB(A)

---



EZ53 Dimensions

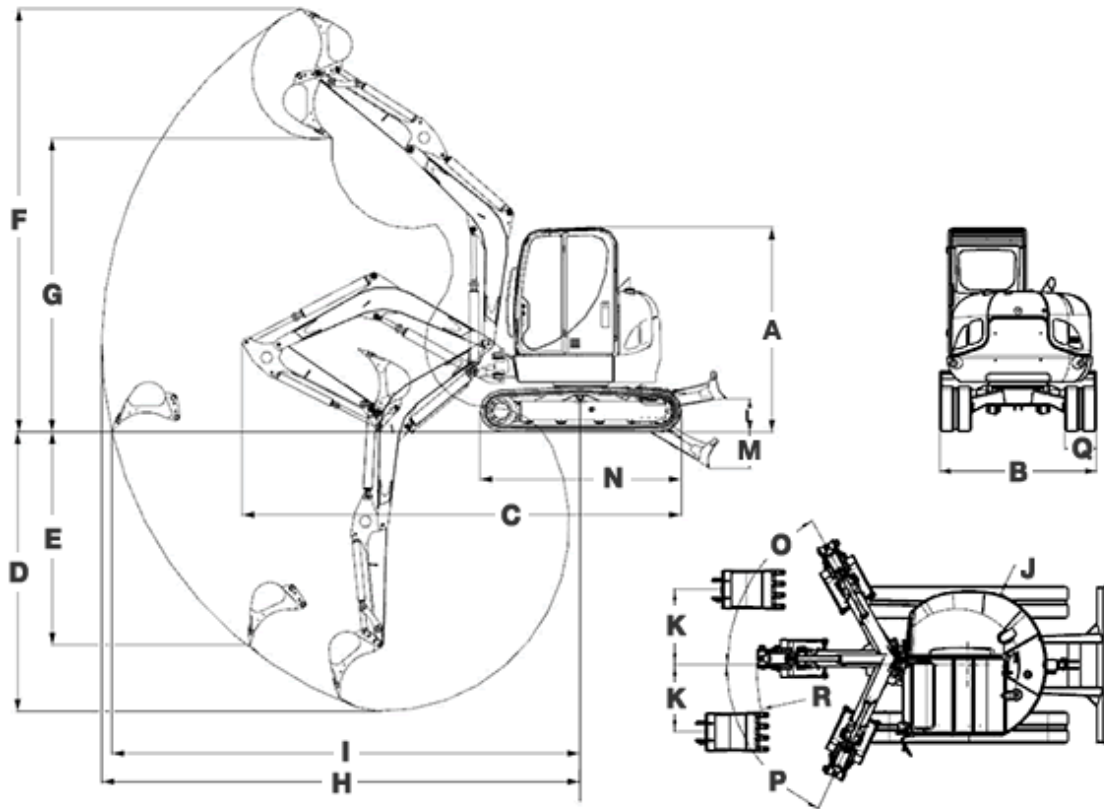

VDS

A	Height	101.3 in	105.2 in
B	Width	78.3 in	78.3 in
B	Width - Revolving superstructure	72.6 in	72.6 in
C	Transport length - Standard Dipperstick	216.5 in	216.1 in
C	Transport length - Long Dipperstick	215.6 in	216.4 in
D	Digging depth max. - Standard Dipperstick	137.8 in	133.6 in
D	Digging depth max. - Long Dipperstick	147.7 in	143.5 in
E	Insertion depth - Standard Dipperstick	105 in	100.1 in
E	Insertion depth - Long Dipperstick	114.4 in	109.5 in



F	Insertion height - Standard Dipperstick	208.6 in	212.8 in
F	Insertion height - Long Dipperstick	214.9 in	219.1 in
G	Dump height max. - Standard Dipperstick	144.8 in	149 in
G	Dump height max. - Long Dipperstick	151.1 in	155.2 in
H	Digging radius max. - Standard Dipperstick	235.7 in	236 in
H	Digging radius max. - Long Dipperstick	245.1 in	245.4 in
I	Range - Standard Dipperstick	230.7 in	229.3 in
I	Range - Long Dipperstick	240.3 in	239 in
J	Rear swivel radius - w/o Counterweight	39.2 in	39.2 in
J	Rear swivel radius - with Counterweight	41.5 in	41.5 in
K	Arm displacement to centre of bucket, right side	37.7 in	37.7 in
K	Arm displacement to centre of bucket, left side	33.6 in	33.6 in
L	Lift height - Above ground	16.3 in	16.3 in
M	Scraping depth - Below ground	17.8 in	17.8 in
N	Length - Track	99.4 in	99.4 in
O	Turning angle - Boom system to the right	61 °	61 °
P	Turning angle - Boom system to the left	65 °	65 °
Q	Chain width	15.7 in	15.7 in
R	Boom slewing radius - Middle	106 in	106 in
R	Boom slewing radius - Right	95.7 in	95.7 in
R	Boom slewing radius - Left	90.1 in	90.1 in



**WACKER  
NEUSON**  
*all it takes!*

Please note

that product availability can vary from country to country. It is possible that information / products may not be available in your country. More detailed information on engine power can be found in the operator's manual; the stated power may vary due to specific operating conditions.

Subject to alterations and errors excepted. Applicable also to illustrations.

Copyright © 2019 Wacker Neuson SE.