

# ET16

## Tracked Conventional Tail Excavators



**WACKER  
NEUSON**  
*all it takes!*



### The most spacious and yet compact of the 1.5t class

The ET16 offers the most powerful drive and largest cab in its class, plus offers flexibility when there is little space to operate. The swivel boom provides the ability to excavate near buildings and job site obstructions, while maintaining great visibility. The ability to move the machine with a small trailer from site to site makes it perfect for landscape projects. Fast transport speeds gets you from place to place on the job site to complete more tasks in less time.

- Load sensing hydraulic system (LUDV) ensures consistent flow regardless of RPM or load changes, providing excellent results when precision matters.
- Large engine hood and removable covers for easy service access.
- Spacious and comfortable cab offers superb all-around visibility as well as leg and headroom.
- Compact footprint is enhanced with telescopic undercarriage and folding dozer blade extension.
- Standard auxiliary hydraulics for easy operation of various attachment tools.

## ET16 Technical specifications

### Operating data

Shipping weight min.	3,090.9 lb
Operating weight	3,370.83 - 3,791.91 lb
Biting force max.	1,776 lbf
Breakout force max.	3,439.6 lbf
Digging depth max.	95 in
Dumping height	93.3 - 99.1 in
Digging radius max.	152.01 in
Superstructure slewing speed	9.8 rev/min
L x W x H	143 x 39 x 90 in

### Engine / Motor

Engine / Motor manufacturer	Yanmar
Engine / Motor type	3TNV80F
Engine / Motor	Water-cooled 3-cylinder diesel engine
Displacement	68 in <sup>3</sup>
RPM / speed	2,200 rpm
Engine performance acc. to ISO	17.6 hp
Battery	44 CCA
Fuel tank capacity	25.3 US gal

### Hydraulic system

Duty pump	Gear pump
Flow rate	8.7 US gpm
Operating pressure for working and traction hydraulics	2,901 psi
Operating pressure Slewing gear	1,885.5 psi

### Undercarriage

Travel speed	2.54 mph
Chain width	9.1 in
Ground clearance	7.1 in

### Dozer Blade

Width (folded in)	39 in
Height	8.5 in
Stroke max., above ground	9.3 in
Stroke max., below ground	10.6 in

### Sound level

Sound level (LwA) acc. to 2000/14/EC	93 dB(A)
Cabin - specified sound pressure level LpA	79 dB(A)

## ET16 Dimensions

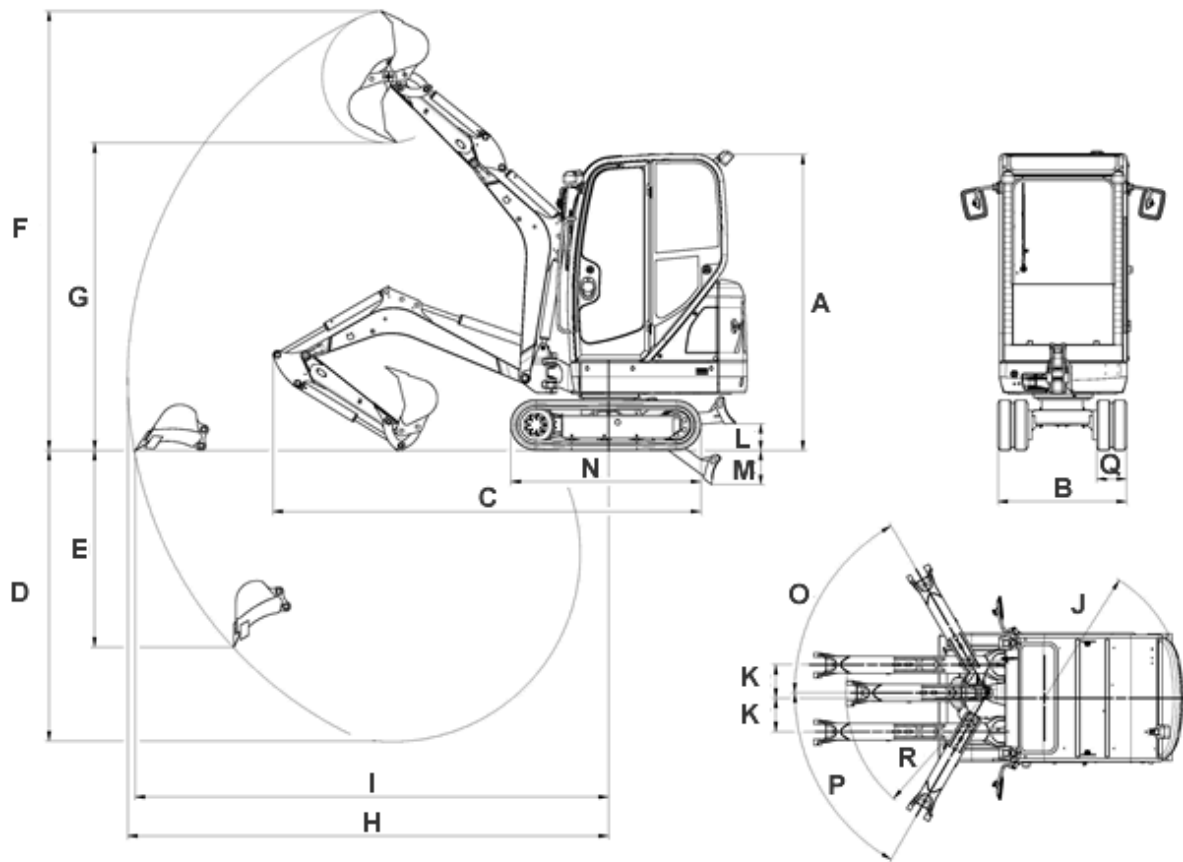

A	Height	90 in	91.2 in
B	Width undercarriage	39 in	39 in
B	Width telescopic undercarriage extended		51.2 in
C	Transport length (bucket arm short)	143.5 in	143.7 in
C	Transport length (bucket arm long)	142 in	142.1 in
D	Digging depth max. (bucket arm short)	88.3 in	86.8 in
D	Digging depth max. (bucket arm long)	95 in	93.5 in
E	Insertion depth vertical (bucket arm short)	64.7 in	63.2 in
E	Insertion depth vertical (bucket arm long)	70.9 in	69.5 in
F	Insertion height (bucket arm short)	133.4 in	134.3 in
F	Insertion height (bucket arm long)	138.1 in	139 in
G	Dump height max. (bucket arm short)	93.4 in	94.4 in
G	Dump height max. (bucket arm long)	98.2 in	99.2 in
H	Digging radius max. (bucket arm short)	145.7 in	145.8 in
H	Digging radius max. (bucket arm long)	152 in	152.1 in
I	Range (bucket arm short)	143.6 in	143.5 in
I	Range (bucket arm long)	150 in	150 in
J	Rear swivel radius	42.3 in	42.4 in
K	Arm displacement max. boom offset to centre of bucket	17 in	17 in

	right side		
K	Arm displacement max. boom offset to centre of bucket left side	11.3 in	11.3 in
L	Lift height max., of dozer blade above ground	8.3 in	9.3 in
M	Scraping depth max., of dozer blade below ground	10.3 in	10.6 in
N	Length total crawler length	57.6 in	57.6 in
O	Turning angle max., of boom system to the right	49 °	49 °
P	Turning angle max., of boom system to the left	73 °	73 °
Q	Chain width	9 in	9.1 in
R	Boom slewing radius	47 in	47.1 in

Please note: that product availability can vary from country to country. It is possible that information / products may not be available in your country. More detailed information on engine power can be found in the operator's manual; the stated power may vary due to specific operating conditions. Subject to alterations and errors excepted. Applicable also to illustrations.  
 Copyright © 2019 Wacker Neuson SE.